

Clutch - Pressure loaded

A . Removing and refitting the closing plate and replacing lip seal (57) and O'ring (1)

Removal

1. Split the tractor between the engine and gearbox (Section 2B01).
2. Drain the gearbox.
3. In order to facilitate unsticking of closing plate (10), install two jacking screws of sufficient length in the tapped holes in the closing plate, then remove the disc.
4. Remove front circlips (58) and remove splined bush (3), backup washers (2) and seal (1).
5. Extract seal (57).

Refitting

6. Fit seal (57) using a suitable fixture.
7. Place O'ring (1) between rings (2). Reinstall splined bush (3). Replace front circlip (58) and position correctly in the groove.
8. Ensure presence of centring pins (61) and shims (9).
9. Replace O'ring (8).
10. Coat tapped-hole surrounds P with Loctite 5206 (Fig. 3).
11. Grease the lip of seal (57). Place protector P/N 3378012M2 (see § F) on shaft (7). Screw two guide studs in opposing locations on the spacer and reinstall closing plate (10), with finger (63) in the slot of pump body (12) (Fig. 4).
12. Install long screws (62) in the same holes as those provided for centring pins (61). Install screws (5), torque to 36 - 46 Nm.
13. Service the oil in the sumps and check on the sightglass located on the left of the centre housing.
14. Reassemble the tractor between the engine and gearbox (see section 2B01) and check adjustment of the chassis reinforcements (if installed) (see section 2F01).

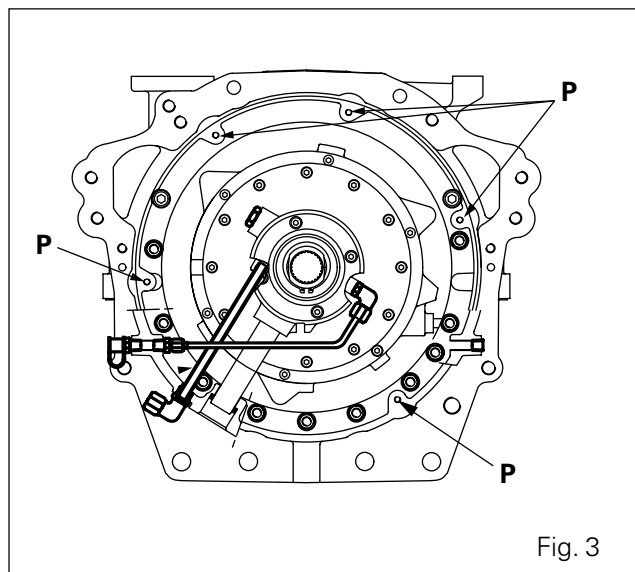

Fig. 3

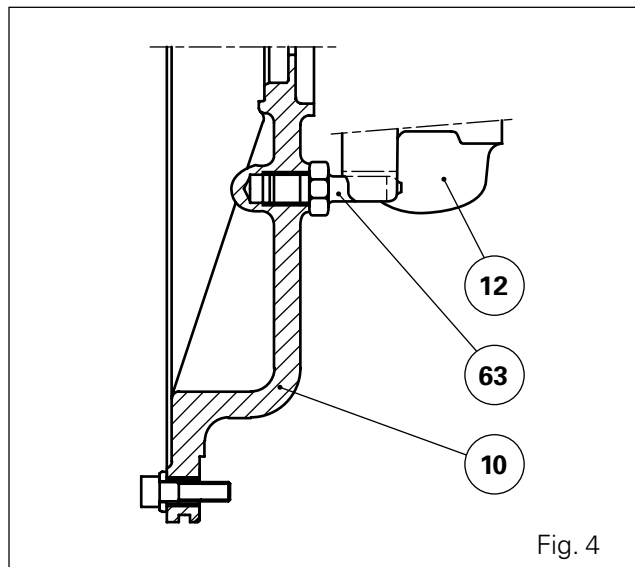

Fig. 4



4A01.8

8200 SERIES TRACTORS



Clutch - Pressure loaded

B. Removing and refitting the clutch

Removal

15. Split the tractor between the engine and gearbox (see section 2B01).
16. Drain the gearbox and the intermediate housing.
Note: Visually identify the contour of the plugs.
17. If the tractor is fitted with chassis reinforcements, it may be necessary to remove the right-hand reinforcement.
18. Remove tube (17).
19. Remove closing plate (10). Repeat operation 3.

20. Remove tube (20).

21. Remove union (72) and tubes (70) and (65).

22. Remove clutch (47) using the locally manufactured tool (Fig. 5 and § F).

Refitting

23. Replace O'rings (14) and (69).

24. Replace O'rings (15) and (71).

25. Refit tubes (20) (65) (70) and union (72).

26. Coat feeler gauges (9) used at operation 45 with miscible grease, and place on pump cover (11).

27. Refit feed tube (2) (Fig. 11).

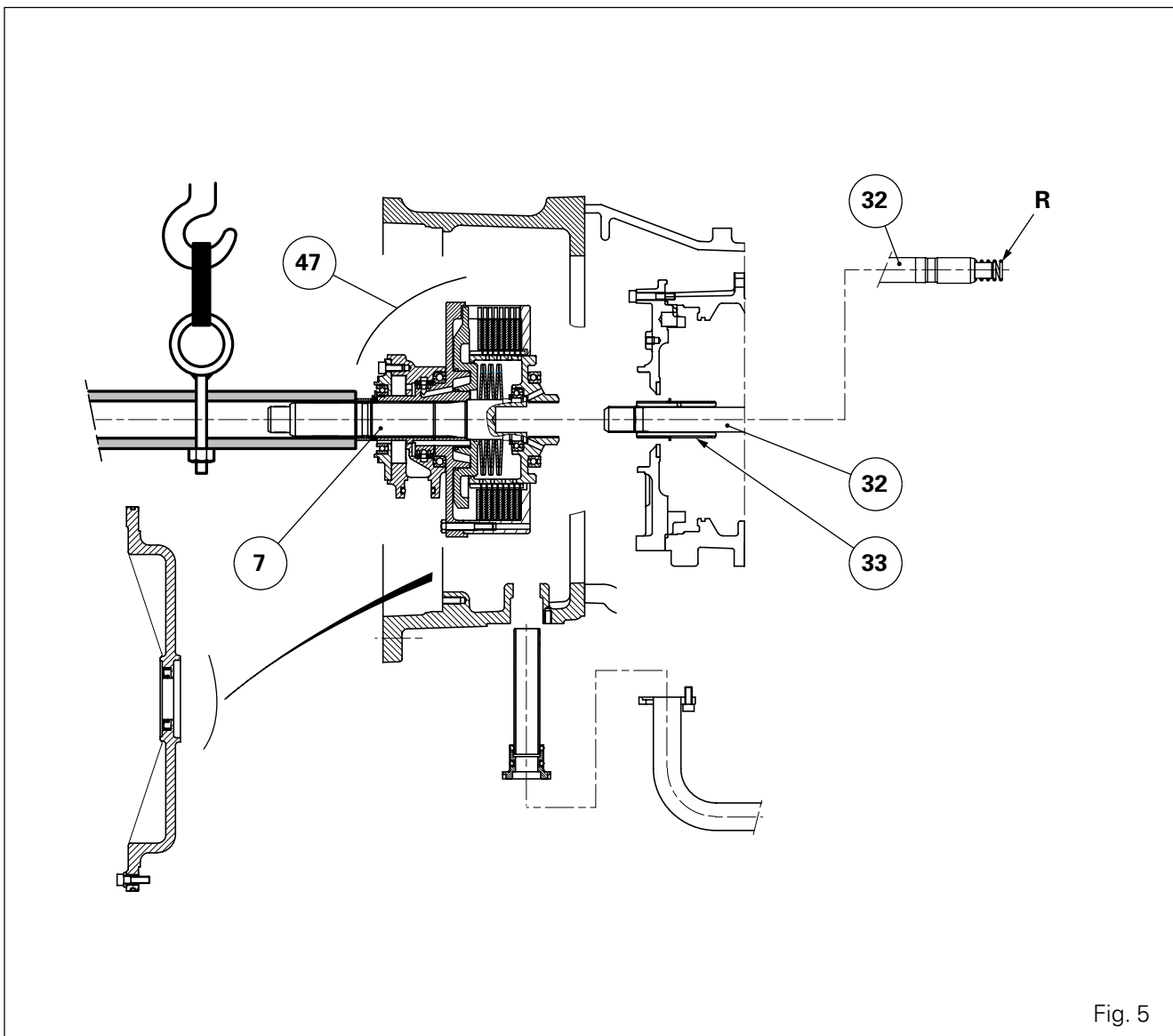

Clutch - Pressure loaded

28. If disassembled, coat finger (63) with Loctite 270 and screw into closing plate (10).
29. Ensure presence of centring pins (61). Replace O'ring (8).
30. Clean and coat hole surrounds P with Loctite 5206 (Fig. 3).
31. Refit the closing plate. Repeat operation 11.
32. Fit screws (5) (62) with washers (6) then insert and torque to 25 - 35 Nm.
Note: The two long screws (62) are installed with centring pins (61).
33. Replace O'rings (28) (29). Reinstall seal holder (30). Install screws (31) and torque to 14 - 20 Nm.
34. Replace dust shield (27). Reinstall tube (17) and flanges (19) and (25), ensuring that groove G in flange (25) is aligned with the face of seal holder (30) (Fig. 7). Tighten screw (26). Torque screws (31) and (38) to 25 - 35 Nm. If disassembled, reinstall and adjust the right-hand chassis reinforcement (see section 2F01).
35. Service the oil in the sumps and check on the sightglass located on the left of the centre housing.
Note: The drain plug in the intermediate housing is special. It has a cylindrical part that is missing on the other plugs. It is therefore essential to observe the position during reassembly.
36. Reassemble the tractor between the engine and gearbox (Section 2B01).
37. Bleed the clutch control valve (see section 9I01) and check the clutch lubrication pressure (see section 9N01).
38. Check the operation of the direct-drive clutch.
39. Road-test the engine clutch.
40. Check the leaktightness of flange (19) and seal holder (30).

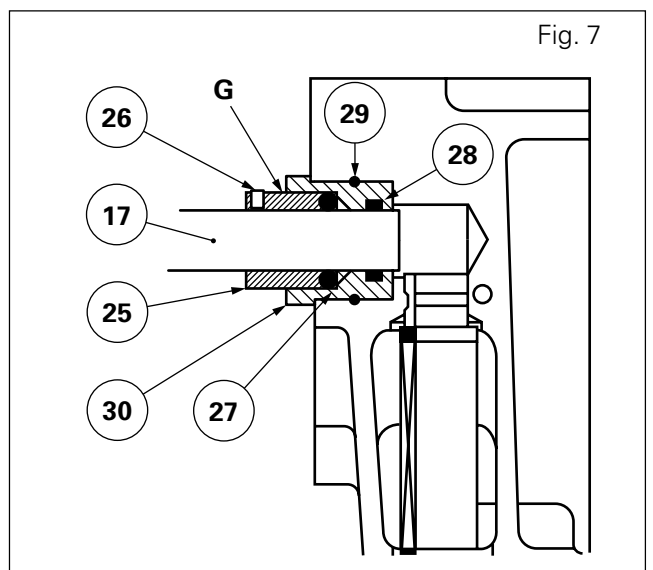
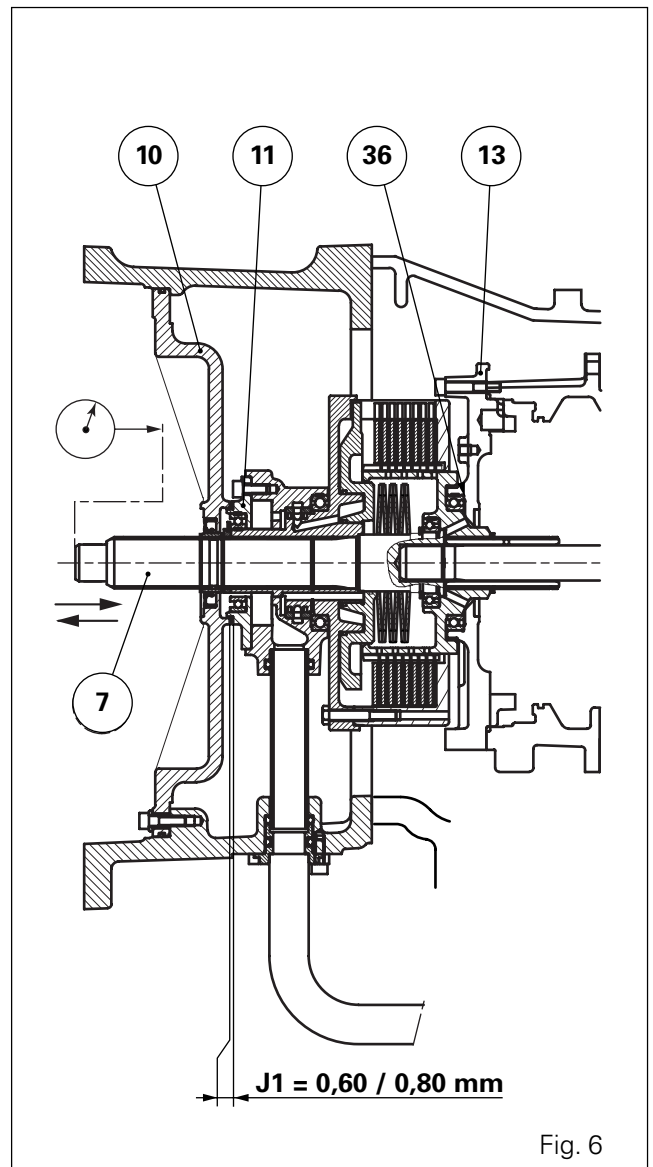



4A01.10

8200 SERIES TRACTORS



Clutch - Pressure loaded

C . Adjusting the clutch

Preliminary operations

41. Remove the clutch (see § B) and Direct-drive shaft (32).
42. Temporarily refit clutch assembly (47) onto clutch shaft (33), using the tool used at operation 22 (and temporarily excluding the direct-drive shaft). Place 2 mm feeler gauge (9) on cover (11).
43. Grease the lip of seal (57). Slide protector 3378012M2 (see § F) over the splines of shaft (7) to protect the seals. Screw two studs in opposing locations on the spacer and reinstall closing plate (10). Install and tighten a few of the screws.

Adjustin

g

Note: This operation consists in obtaining an axial clearance of $J1 = 0.60$ to 0.80 mm between pump cover (11) and closing plate (10) (Fig. 6)

44. Install a dial-gauge comparator on the end of shaft (7) and check the play by moving the clutch assembly sideways.
Note: Ensure bearing (36) in the clutch assembly is fully abutted against cover (13) before pulling on the shaft (Fig. 6)
45. Remove closing plate (10); depending on the measured clearance, select thickness of feeler gauges (9) to obtain a clearance **J1 of between 0.6 and 0.8 mm.**

Final operations

46. Remove the clutch and reinstall Direct-drive shaft (32), turning the undercut part (designed to receive spring R towards the rear axle (Fig. 5).
47. Proceed to final refitting of the clutch assembly (see § B).