

4. Remove cylinder end cap (A) and shim(s) (B).
5. Remove piston rod (C) and cylinder barrel (D).
6. Remove rod guide (E) by pushing it to opposite end of cylinder bore with a wooden dowel.

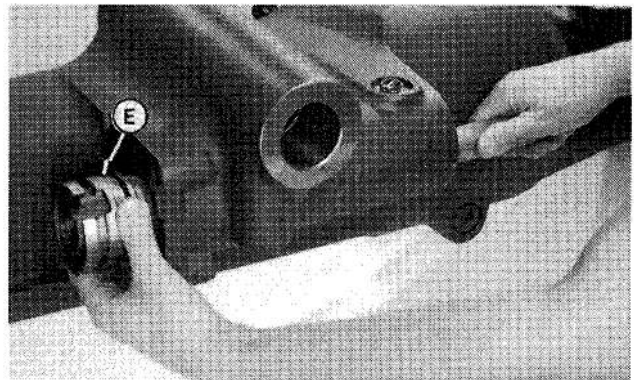
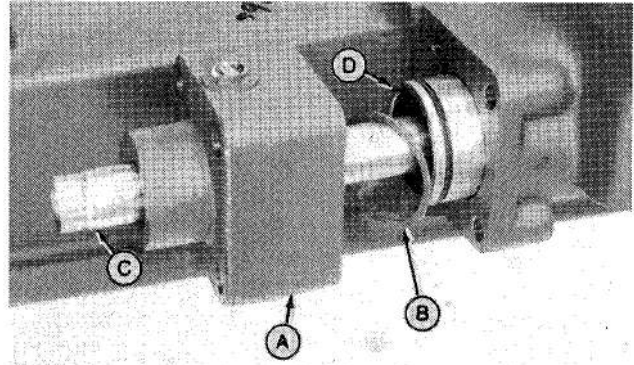

A—Cylinder End Cap  
 B—Shim(s)  
 C—Piston Rod  
 D—Cylinder  
 E—Rod Guide

6NA;T6382I K T6382I M T47;;0260 -A53 020687

7. Remove wiper ring (A), piston seal (B), retaining ring (C), collar (D), and one set of locking halves (E).

With a soft faced hammer, drive piston (F) off other set of locking halves (G). Remove locking halves, piston and O-ring (H).

**IMPORTANT: Piston I.D. O-ring must be replaced after each disassembly of piston.**

8. Replace O-rings and seals. Apply petroleum jelly to piston I.D. O-ring.

9. Reassemble piston.

A—Wiper Ring  
 B—Piston Seal  
 C—Retaining Ring  
 E—Locking Halves  
 F—Piston  
 G—Locking Halves  
 H—O-Ring

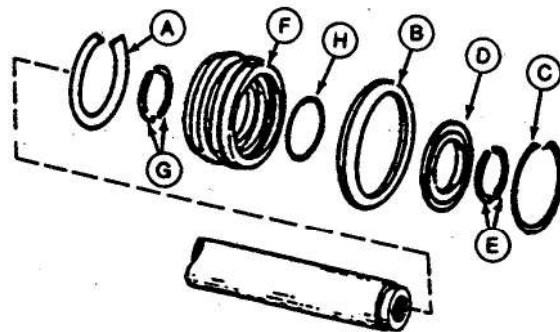

6NA;T6382J V T47;;0260 -A54 020687